

NOTES
THIS DRAWING IS TO BE READ IN CONJUNCTION WITH ALL OTHER RELEVANT DOCUMENTATION.

LEGEND

- THE SCHEME
- LIMITS OF LAND TO BE ACQUIRED OR USED PERMANENTLY OR TEMPORARILY (THE ORDER LIMITS)
- LIMITS OF LAND TO BE TEMPORARILY ACQUIRED FOR SIGNAGE INSTALLATION
- LAND NOT INCLUDED WITHIN THE ORDER LIMITS
- LANDSCAPE - NATIVE HEDGE PLANTING - LE 4.2
- LANDSCAPE - GRASSLAND - (LE 1.1 - 2M VERGE) (LE 1.3 SPECIES RICH GRASSLAND ON ALL OTHER AREAS)
- LANDSCAPE - WOODLAND/WOODLAND EDGE - LE 2.1 / LE 2.2
- LANDSCAPE - SHRUB WITH INTERMITTENT TREES - LE 2.5
- LANDSCAPE - SHRUB - LE 2.6
- LANDSCAPE - SCRUB - LE 2.8
- ECOLOGICAL - RETAINED WOODLAND HABITAT
- ECOLOGICAL - RETAINED GRASSLAND HABITAT
- ECOLOGICAL - RETAINED AREA OF EXISTING WATER
- ECOLOGICAL - MITIGATION (PROPOSED GRASSLAND & SCRUB)
- ECOLOGICAL - PROPOSED AREA FOR HABITAT TRANSLOCATION
- ECOLOGICAL - PROPOSED AREA FOR POSSIBLE ANCIENT WOODLAND TRANSLOCATION
- ECOLOGICAL - PROPOSED REED BEDS
- PROPOSED CARRIAGEWAY/HARD STANDING/ACCESS TRACKS
- LAND IDENTIFIED FOR BIODIVERSITY OFFSETTING MEASURES
- Sealed Collection Sumps
- Proposed Below Ground Piping
- Recharge Feature
- Proposed Ditch

ECOLOGICAL MITIGATION

- BAT BOXES - ENHANCEMENT (ALSO FOCUS BIRD BOXES ON RETAINED WOODLAND FOR ENHANCEMENT)
- BAT BOXES - MITIGATION
- NEWT MITIGATION - RECEPTOR AREA IN BOUNDARY HEDGE, PLANTING AS SPECIFIED WITH LOG PILES / HIBERNICOLA
- NEWT MITIGATION - RECEPTOR AREA, PLANTING AS SPECIFIED WITH LOG PILES / HIBERNICOLA
- BADGER - FENCING
- BADGER - MAMMAL TUNNEL

PLANNED ENVIRONMENTAL OBJECTIVES

- EFA VISUAL SCREENING
- EFB LANDSCAPE INTEGRATION
- EFD NATURE CONSERVATION AND BIODIVERSITY

FIRST ISSUE	GB	JG	13/12/18	C01
Revision Details	By	Check	Date	Suffix
Purpose of Issue				
DCO SUBMISSION				
Client Highways England Floor 5 Two Colmore Square 38 Colmore Circus B4 6BN				
Development Consent Order Number TR010027				
Project Title M42 JUNCTION 6 IMPROVEMENT				
Drawing Title FIGURE 8.8 ENVIRONMENTAL MASTERPLAN SHEET 1 OF 3				
Designed JA	Drawn GB	Checked JA	Approved JG	Date 13/12/18
Internal Project No 60543032		Suitability D7		
Scale @ A3 1:7,500		Zone M42		
THIS DOCUMENT HAS BEEN PREPARED PURSUANT TO AND SUBJECT TO THE TERMS OF AECOM'S APPOINTMENT BY ITS CLIENT. AECOM ACCEPTS NO LIABILITY FOR ANY USE OF THIS DOCUMENT OTHER THAN BY ITS ORIGINAL CLIENT OR FOLLOWING AECOM'S EXPRESS AGREEMENT TO SUCH USE, AND ONLY FOR THE PURPOSES FOR WHICH IT WAS PREPARED AND PROVIDED.				
Drawing Number HE551485 -ACM		Originator -EGN-		Rev C01
Location M42_SW_ZZ_ZZ		Type Role Number -DR-DC-0195		

File name: K:\GIS Management\60543032 - M42 Jct 6 GIS Folder - GIS01 - Maps\100 - Figures\New Template\Figure 8.8.mxd



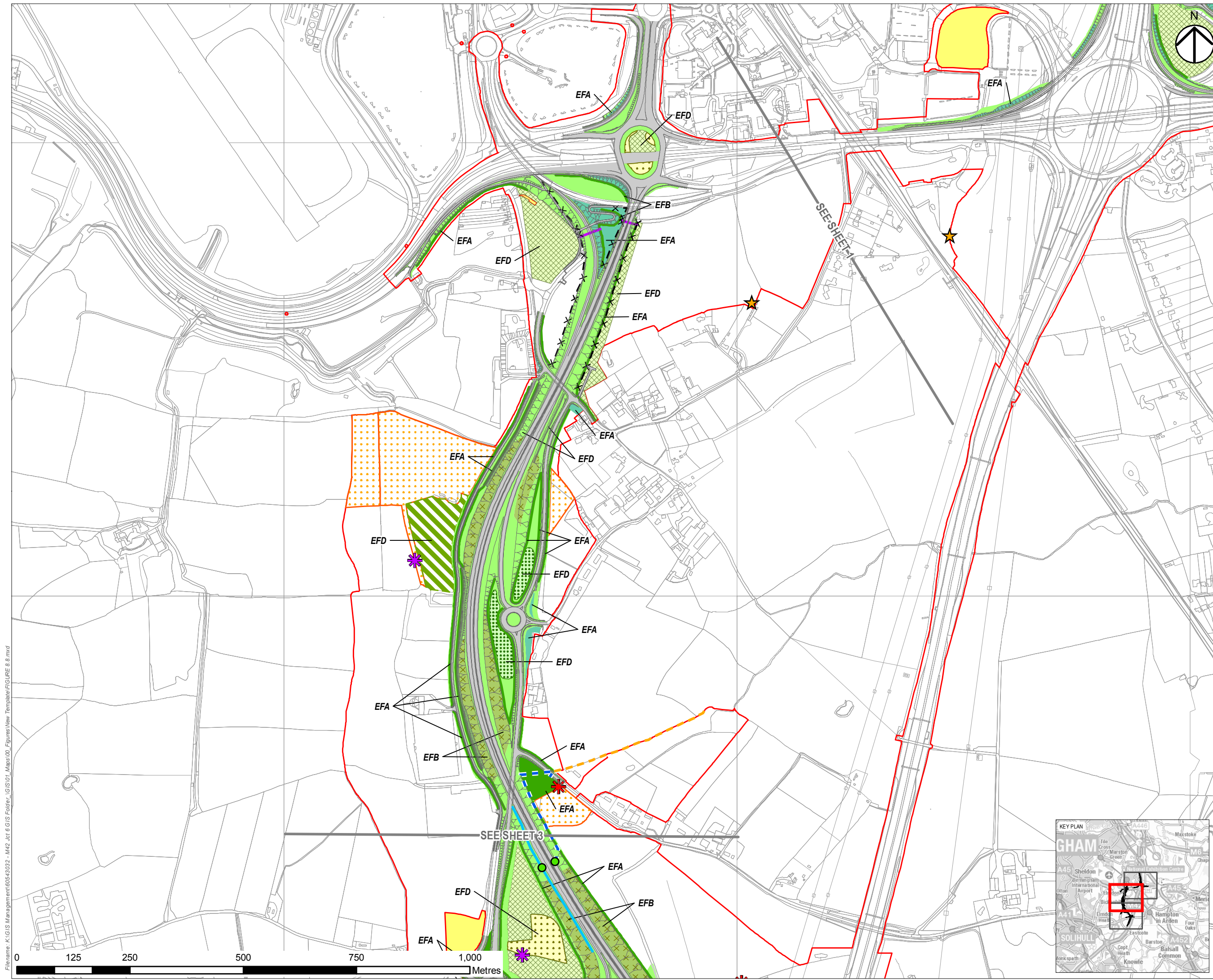

NOTES
THIS DRAWING IS TO BE READ IN CONJUNCTION WITH ALL OTHER RELEVANT DOCUMENTATION.

LEGEND

- THE SCHEME
- LIMITS OF LAND TO BE ACQUIRED OR USED PERMANENTLY OR TEMPORARILY (THE ORDER LIMITS)
- LIMITS OF LAND TO BE TEMPORARILY ACQUIRED FOR SIGNAGE INSTALLATION
- LAND NOT INCLUDED WITHIN THE ORDER LIMITS
- LANDSCAPE - NATIVE HEDGE PLANTING - LE 4.2
- LANDSCAPE - GRASSLAND - (LE 1.1 - 2M VERGE) (LE 1.3 SPECIES RICH GRASSLAND ON ALL OTHER AREAS)
- LANDSCAPE - WOODLAND/WOODLAND EDGE - LE 2.1 / LE 2.2
- LANDSCAPE - SHRUB WITH INTERMITTENT TREES - LE 2.5
- LANDSCAPE - SHRUB - LE 2.6
- LANDSCAPE - SCRUB - LE 2.8
- ECOLOGICAL - RETAINED WOODLAND HABITAT
- ECOLOGICAL - RETAINED GRASSLAND HABITAT
- ECOLOGICAL - RETAINED AREA OF EXISTING WATER
- ECOLOGICAL - MITIGATION (PROPOSED GRASSLAND & SCRUB)
- ECOLOGICAL - PROPOSED AREA FOR HABITAT TRANSLOCATION
- ECOLOGICAL - PROPOSED AREA FOR POSSIBLE ANCIENT WOODLAND TRANSLOCATION
- ECOLOGICAL - PROPOSED REED BEDS
- PROPOSED CARRIAGEWAY/HARD STANDING/ACCESS TRACKS
- LAND IDENTIFIED FOR BIODIVERSITY OFFSETTING MEASURES
- Sealed Collection Sumps
- Proposed Below Ground Piping
- Recharge Feature
- Proposed Ditch

ECOLOGICAL MITIGATION

- BAT BOXES - ENHANCEMENT (ALSO FOCUS BIRD BOXES ON RETAINED WOODLAND FOR ENHANCEMENT)
- BAT BOXES - MITIGATION
- NEWT MITIGATION - RECEPTOR AREA IN BOUNDARY HEDGE, PLANTING AS SPECIFIED WITH LOG PILES / HIBERNACULA
- NEWT MITIGATION - RECEPTOR AREA, PLANTING AS SPECIFIED WITH LOG PILES / HIBERNACULA
- BADGER - FENCING
- BADGER - MAMMAL TUNNEL

PLANNED ENVIRONMENTAL OBJECTIVES

- EFA VISUAL SCREENING
- EFB LANDSCAPE INTEGRATION
- EFC NATURE CONSERVATION AND BIODIVERSITY

Revision	Details	By	Check	Date	Suffix
FIRST ISSUE		GB	JG	13/12/18	C01

Purpose of Issue: **DCO SUBMISSION**

Client: **Highways England**
 Floor 5
 Two Colmore Square
 38 Colmore Circus
 B4 6BN

Development Consent Order Number: **TR010027**

Project Title: **M42 JUNCTION 6 IMPROVEMENT**

Drawing Title: **FIGURE 8.8 ENVIRONMENTAL MASTERPLAN SHEET 2 OF 3**

Designed	Drawn	Checked	Approved	Date
JA	GB	JA	JG	13/12/18

Internal Project No: 60543032 | Suitability: D7
 Scale @ A3: 1:7,500 | Zone: M42

THIS DOCUMENT HAS BEEN PREPARED PURSUANT TO AND SUBJECT TO THE TERMS OF AECOM'S APPOINTMENT BY ITS CLIENT. AECOM ACCEPTS NO LIABILITY FOR ANY USE OF THIS DOCUMENT OTHER THAN BY ITS ORIGINAL CLIENT OR FOLLOWING AECOM'S EXPRESS AGREEMENT TO SUCH USE, AND ONLY FOR THE PURPOSES FOR WHICH IT WAS PREPARED AND PROVIDED.

Drawing Number	Originator	Volume	Rev
HE551485 -ACM	-EGN-		C01

Location: M42_SW_ZZ_ZZ -DR-DC-0196 | Type: 1 | Role: | Number:

Filename: K:\GIS Management\60543032 - M42 Jct 6 GIS folder - GIS\01 - Maps\00 - Figures\New Template\FIGURE 8.8.mxd



NOTES
THIS DRAWING IS TO BE READ IN CONJUNCTION WITH ALL OTHER RELEVANT DOCUMENTATION.

LEGEND

- THE SCHEME
- LIMITS OF LAND TO BE ACQUIRED OR USED PERMANENTLY OR TEMPORARILY (THE ORDER LIMITS)
- LIMITS OF LAND TO BE TEMPORARILY ACQUIRED FOR SIGNAGE INSTALLATION
- LAND NOT INCLUDED WITHIN THE ORDER LIMITS
- LANDSCAPE - NATIVE HEDGE PLANTING - LE 4.2
- LANDSCAPE - GRASSLAND - (LE 1.1 - 2M VERGE) (LE 1.3 SPECIES RICH GRASSLAND ON ALL OTHER AREAS)
- LANDSCAPE - WOODLAND/WOODLAND EDGE - LE 2.1 / LE 2.2
- LANDSCAPE - SHRUB WITH INTERMITTENT TREES - LE 2.5
- LANDSCAPE - SHRUB - LE 2.6
- LANDSCAPE - SCRUB - LE 2.8
- ECOLOGICAL - RETAINED WOODLAND HABITAT
- ECOLOGICAL - RETAINED GRASSLAND HABITAT
- ECOLOGICAL - RETAINED AREA OF EXISTING WATER
- ECOLOGICAL - MITIGATION (PROPOSED GRASSLAND & SCRUB)
- ECOLOGICAL - PROPOSED AREA FOR HABITAT TRANSLOCATION
- ECOLOGICAL - PROPOSED AREA FOR POSSIBLE ANCIENT WOODLAND TRANSLOCATION
- ECOLOGICAL - PROPOSED REED BEDS
- PROPOSED CARRIAGEWAY/HARD STANDING/ACCESS TRACKS
- LAND IDENTIFIED FOR BIODIVERSITY OFFSETTING MEASURES
- Sealed Collection Sumps
- Proposed Below Ground Piping
- Recharge Feature
- Proposed Ditch

ECOLOGICAL MITIGATION

- BAT BOXES - ENHANCEMENT (ALSO FOCUS BIRD BOXES ON RETAINED WOODLAND FOR ENHANCEMENT)
- BAT BOXES - MITIGATION
- NEWT MITIGATION - RECEPTOR AREA IN BOUNDARY HEDGE, PLANTING AS SPECIFIED WITH LOG PILES / HIBERNACULA
- NEWT MITIGATION - RECEPTOR AREA, PLANTING AS SPECIFIED WITH LOG PILES / HIBERNACULA
- BADGER - FENCING
- BADGER - MAMMAL TUNNEL

PLANNED ENVIRONMENTAL OBJECTIVES

- EFA VISUAL SCREENING
- EFB LANDSCAPE INTEGRATION
- EFD NATURE CONSERVATION AND BIODIVERSITY

FIRST ISSUE	GB	JG	13/12/18	C01
Revision Details	By	Check	Date	Suffix
Purpose of Issue				
DCO SUBMISSION				
Client Highways England Floor 5 Two Colmore Square 38 Colmore Circus B4 6BN				
Development Consent Order Number TR010027				
Project Title M42 JUNCTION 6 IMPROVEMENT				
Drawing Title FIGURE 8.8 ENVIRONMENTAL MASTERPLAN SHEET 3 OF 3				
Designed JA	Drawn GB	Checked JA	Approved JG	Date 13/12/18
Internal Project No 60543032			Suitability D7	
Scale @ A3 1:7,500			Zone M42	
THIS DOCUMENT HAS BEEN PREPARED PURSUANT TO AND SUBJECT TO THE TERMS OF AECOM'S APPOINTMENT BY ITS CLIENT. AECOM ACCEPTS NO LIABILITY FOR ANY USE OF THIS DOCUMENT OTHER THAN BY ITS ORIGINAL CLIENT OR FOLLOWING AECOM'S EXPRESS AGREEMENT TO SUCH USE, AND ONLY FOR THE PURPOSES FOR WHICH IT WAS PREPARED AND PROVIDED.				
Drawing Number Highways England Proj Originator Volume HE551485 -ACM -EGN-				Rev C01
Location M42 SW ZZ ZZ -DR-DC-0197				Type Role Number

Filename: K:\GIS Management\60543032 - M42 Jct 6 GIS folder - GIS01 - Maps\00 - Figures\New Template\Figure 8.8.mxd

This map is based upon Ordnance Survey material with the permission of Ordnance Survey on behalf of the Controller of Her Majesty's Stationery Office © Crown copyright. Unauthorised reproduction infringes Crown copyright and may lead to prosecution or civil proceedings. Highways England 100030649 2018